

# EagleRidge Lodge / Townhomes

<b>AREA</b>	Mountain-South Side
<b>ADDRESS</b>	1463 Flattop Circle
<b>MGMT. COMPANY</b>	Steamboat Resorts
<b>MGMT. CO. CONTACT</b>	
<b>MGMT. CO. PHONE</b>	970-879-5555
<b>WEBSITE</b>	steamboatresorts.com
<b>YEAR BUILT</b>	2001
<b>ON-SITE CHECK-IN</b>	Yes
<b>SKI-IN/SKI-OUT</b>	No
<b>PETS</b>	Owners Only
<b>SHUTTLE</b>	Seasonal
<b>RENTALS</b>	Nightly, Long-Term
<b>RIGHT OF FIRST REFUSAL</b>	No
<b>WORKING CAPITAL</b>	Yes
<b>GARAGE</b>	No
<b>ELEVATOR</b>	No
<b>MAIN LEVEL MASTER</b>	Yes



UNIT TYPE	# OF UNITS	SQUARE FEET
1 Bed/1 Bath	44	673 sf
2 Bed/2 Bath	79	841 sf
3 Bed/2 Bath	12	1165 sf

## HOA AMENITIES

- Outdoor Pool
- 2 Outdoor Hot Tub
- Gas Grill

## HOA FEE INCLUDES

- Water
- Sewer
- Cable TV
- Internet
- Trash Service
- Lawn Maintenance
- Insurance
- Building Maintenance
- Snow Plowing
- Snow Shoveling
- Capital Reserves
- Common Amenities

## UNIT/PROPERTY AMENITIES

- Outdoor Pool & 2 Hot Tubs
- Free Parking
- Access to City Bus
- Fully Equipped Kitchen
- Washer & Dryer in unit
- Gas Fireplace
- Cable TV
- Internet

Steamboat

**Sotheby's**  
INTERNATIONAL REALTY

steamboatsir.com | Main 970.879.8100 | Mountain 970.879.7800 | Downtown 970.870.8885

*\*This information is believed to be accurate but is not guaranteed, and is subject to change.\**

# EagleRidge Lodge / Townhomes



Steamboat

**Sotheby's**  
INTERNATIONAL REALTY

steamboatsir.com | Main 970.879.8100 | Mountain 970.879.7800 | Downtown 970.870.8885

*\*This information is believed to be accurate but is not guaranteed, and is subject to change.\**

# THE TERRACES AT EAGLE RIDGE

<b>AREA</b>	Mountain-South Side
<b>ADDRESS</b>	2700 Eagle Ridge Dr
<b>MGMT. COMPANY</b>	Mountain Resorts
<b>MGMT. CO. CONTACT</b>	Lisa Joens Van Pelt
<b>MGMT. CO. PHONE</b>	970-879-3700
<b>WEBSITE</b>	mtn-resorts.com
<b>YEAR BUILT</b>	1995
<b>ON-SITE CHECK-IN</b>	No
<b>SKI-IN/SKI-OUT</b>	No
<b>PETS</b>	Owners Only
<b>SHUTTLE</b>	Yes
<b>RENTALS</b>	Nightly, Long-Term
<b>RIGHT OF FIRST REFUSAL</b>	No
<b>WORKING CAPITAL</b>	No
<b>GARAGE</b>	Parking Garage
<b>ELEVATOR</b>	Yes
<b>MAIN LEVEL MASTER</b>	Yes



UNIT TYPE	# OF UNITS	SQUARE FEET
2 Bed / 2 Bath	20	900 sf +/-
2 Bed / 2.5 Bath	1	1317 sf
2 Bed / 3 Bath	1	1540 sf
3 Bed / 2.5 Bath	2	1600 sf +/-
3 Bed / 2.5 Bath	1	2219 sf
3 Bed / 3.5 Bath	2	1848 sf

## HOA AMENITIES

- Walk-to-Ski
- Private Shuttle
- Outdoor Pool & Hot Tub
- Fitness Center
- Covered Parking

## HOA FEE INCLUDES

- Gas
- Water
- Sewer
- Trash Service
- Lawn Maintenance
- Insurance
- Building Maintenance
- Shuttle Service
- Road Maintenance
- Snow Plowing
- Snow Shoveling
- Common Amenities

## UNIT/PROPERTY AMENITIES

- Fully Equipped Kitchen
- Washer & Dryer in Unit
- Gas Fireplace
- Cable & Wireless Internet
- Covered Terraces

Steamboat

**Sotheby's**  
INTERNATIONAL REALTY

steamboatsir.com | Main 970.879.8100 | Mountain 970.879.7800 | Downtown 970.870.8885

*\*This information is believed to be accurate but is not guaranteed, and is subject to change.\**

# THE TERRACES AT EAGLE RIDGE

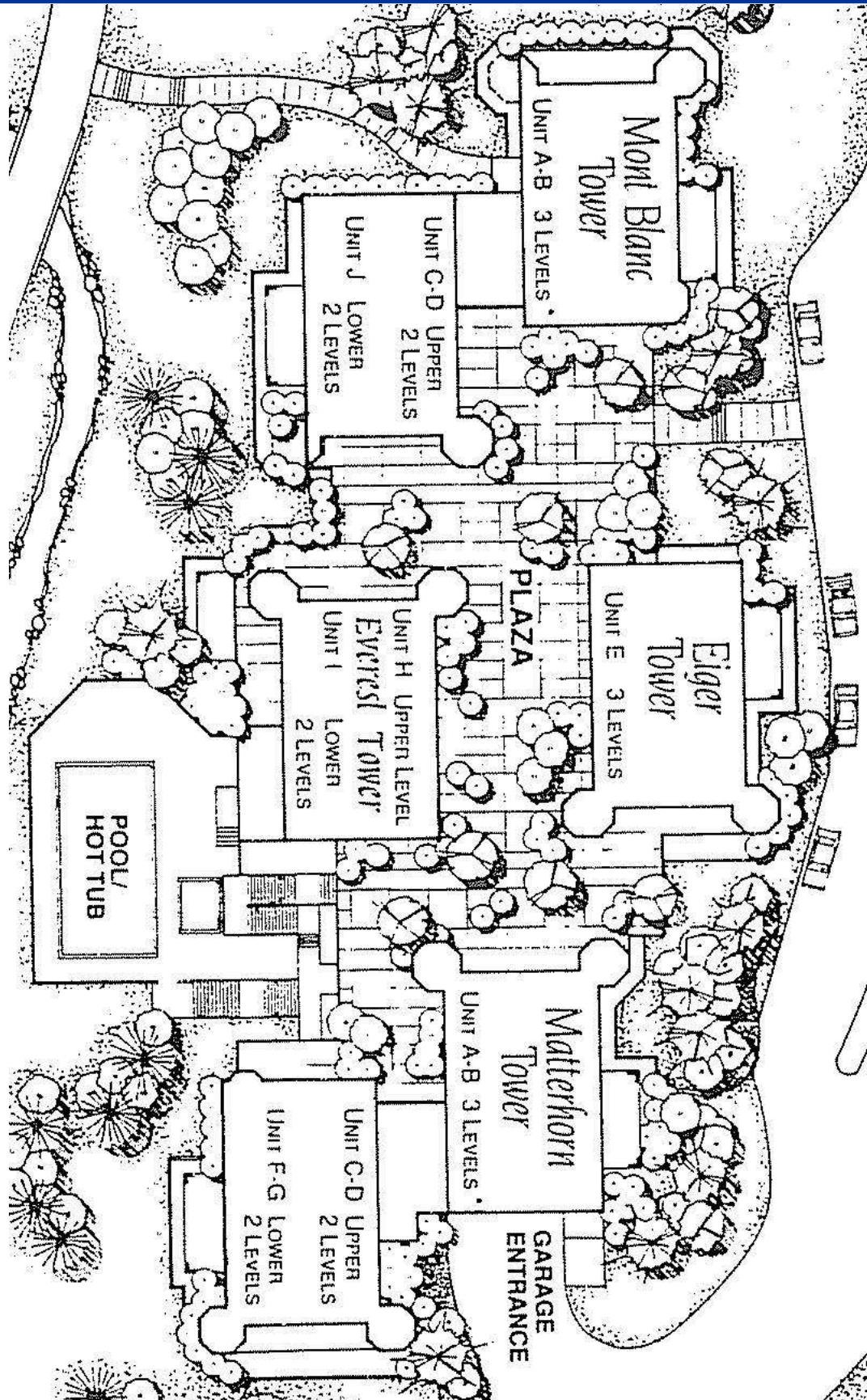

Steamboat

**Sotheby's**  
INTERNATIONAL REALTY

steamboatsir.com | Main 970.879.8100 | Mountain 970.879.7800 | Downtown 970.870.8885

*\*This information is believed to be accurate but is not guaranteed, and is subject to change.\**