

THE LODGE AT STEAMBOAT

AREA	Mountain-South Side
ADDRESS	2700 Village Drive
MGMT. COMPANY	Steamboat Resorts
MGMT. CO. CONTACT	Andy Weynand
MGMT. CO. PHONE	970-879-6000
WEBSITE	n/a
YEAR BUILT	1980
ON-SITE CHECK-IN	Yes
SKI-IN/SKI-OUT	One Block
PETS	Owners Only
SHUTTLE	Yes, Seasonal
RENTALS	Nightly, Long-Term
RIGHT OF FIRST REFUSAL	No
WORKING CAPITAL	
GARAGE	Covered Parking Garage
ELEVATOR	No
MAIN LEVEL MASTER	No



UNIT TYPE	# OF UNITS	SQUARE FEET
2 Bed/2 Bath	84	1041 sf
3 Bed/3 Bath	24	1288 sf

HOA AMENITIES

- Outdoor Hot Tubs
- Indoor Hot Tub
- Pool
- Tennis
- Clubhouse
- HOA Shuttle
- Concierge

HOA FEE INCLUDES

- Gas
- Water
- Sewer
- Cable TV
- Trash Service
- Lawn Maintenance
- Building Insurance
- Building Maintenance
- Snow Removal
- Shuttle Service
- Capital Reserves
- Common Amenities

UNIT/PROPERTY AMENITIES

- One Block from Gondola Square
- On-Site Management
- On-Site Check-In
- Laundry Facilities
- Fireplaces
- Private Balconies
- High Speed Internet
- Private Ski Storage
- Ski Valet Services
- Continental Breakfast/Coffee
- On Free City Bus Route

Steamboat

Sotheby's
INTERNATIONAL REALTY

steamboatsir.com | Main 970.879.8100 | Mountain 970.879.7800 | Downtown 970.870.8885

This information is believed to be accurate but is not guaranteed, and is subject to change.

THE LODGE AT STEAMBOAT

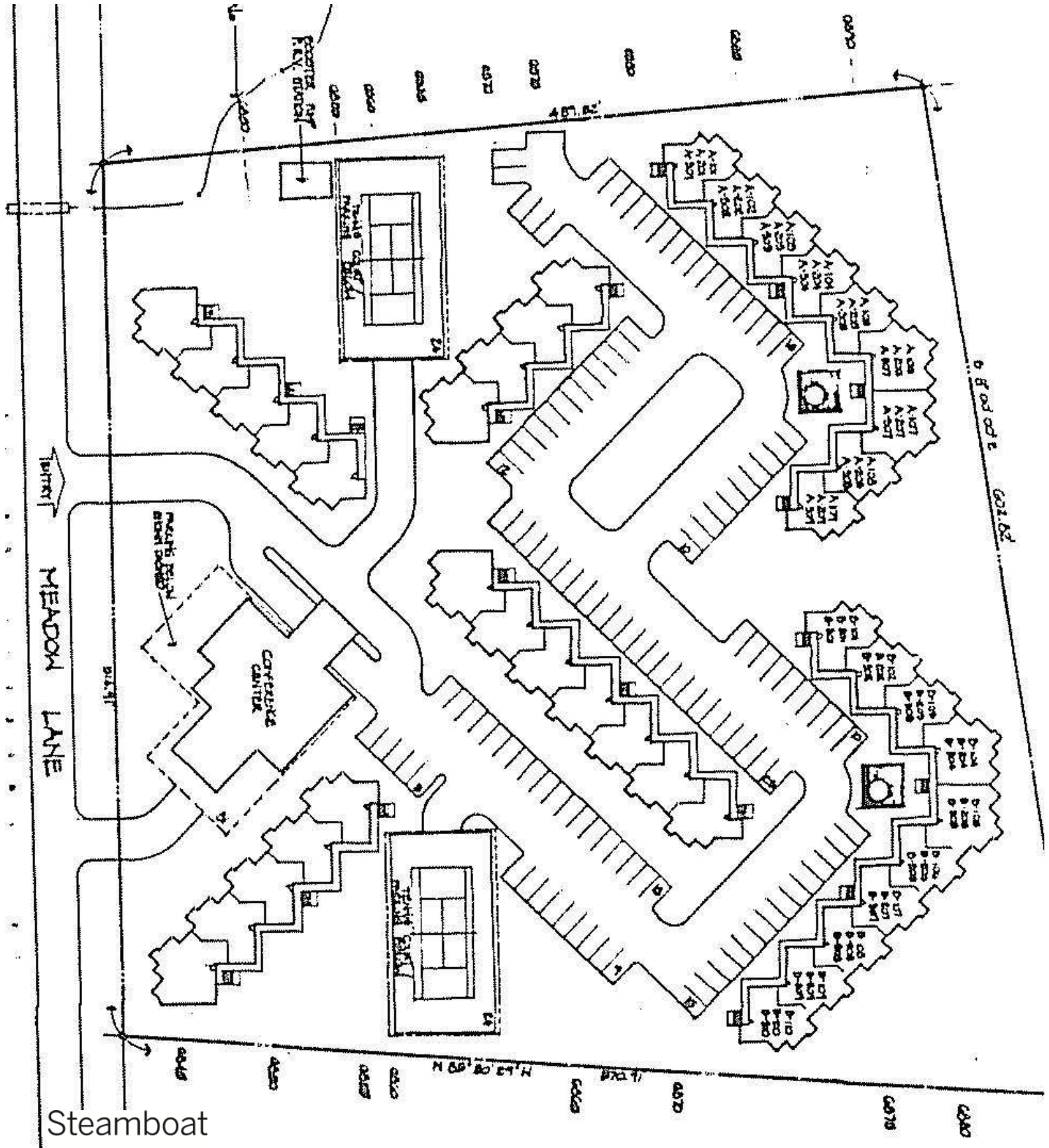

Steamboat

Sotheby's
INTERNATIONAL REALTY

steamboatsir.com | Main 970.879.8100 | Mountain 970.879.7800 | Downtown 970.870.8885

This information is believed to be accurate but is not guaranteed, and is subject to change.