

# SHADOW RUN CONDOMINIUMS

AREA	Mountain-South Side
ADDRESS	2900 Whistler Road
MGMT. COMPANY	Mountain Resorts
MGMT. CO. CONTACT	Karrie Littman
MGMT. CO. PHONE	970-879-3700
WEBSITE	www.ShadowRunCondominiums.com
YEAR BUILT	1980
ON-SITE CHECK-IN	No
SKI-IN/SKI-OUT	No
PETS	Owners Only
SHUTTLE	No
RENTALS	Nightly, Long-Term
RIGHT OF FIRST REFUSAL	No
WORKING CAPITAL	Yes
GARAGE	No
ELEVATOR	No
MAIN LEVEL MASTER	Yes



UNIT TYPE	# OF UNITS	SQUARE FEET
1 Bed/1 Bath	44	673 sf
2 Bed/2 Bath	79	841 sf
3 Bed/2 Bath	12	1165 sf

## HOA AMENITIES

- Outdoor Pool
- 2 Outdoor Hot Tub
- Gas Grill

## HOA FEE INCLUDES

- Water
- Sewer
- Cable TV
- Internet
- Trash Service
- Lawn Maintenance
- Insurance
- Building Maintenance
- Snow Plowing
- Snow Shoveling
- Capital Reserves
- Common Amenities

## UNIT/PROPERTY AMENITIES

- Outdoor Pool & 2 Hot Tubs
- Free Parking
- Access to City Bus
- Fully Equipped Kitchen
- Washer & Dryer in unit
- Gas Fireplace
- Cable TV
- Internet

Steamboat

**Sotheby's**  
INTERNATIONAL REALTY

steamboatsir.com | Main 970.879.8100 | Mountain 970.879.7800 | Downtown 970.870.8885

*\*This information is believed to be accurate but is not guaranteed, and is subject to change.\**

# SHADOW RUN CONDOMINIUMS

SHADOW RUN CONDOMINIUM.

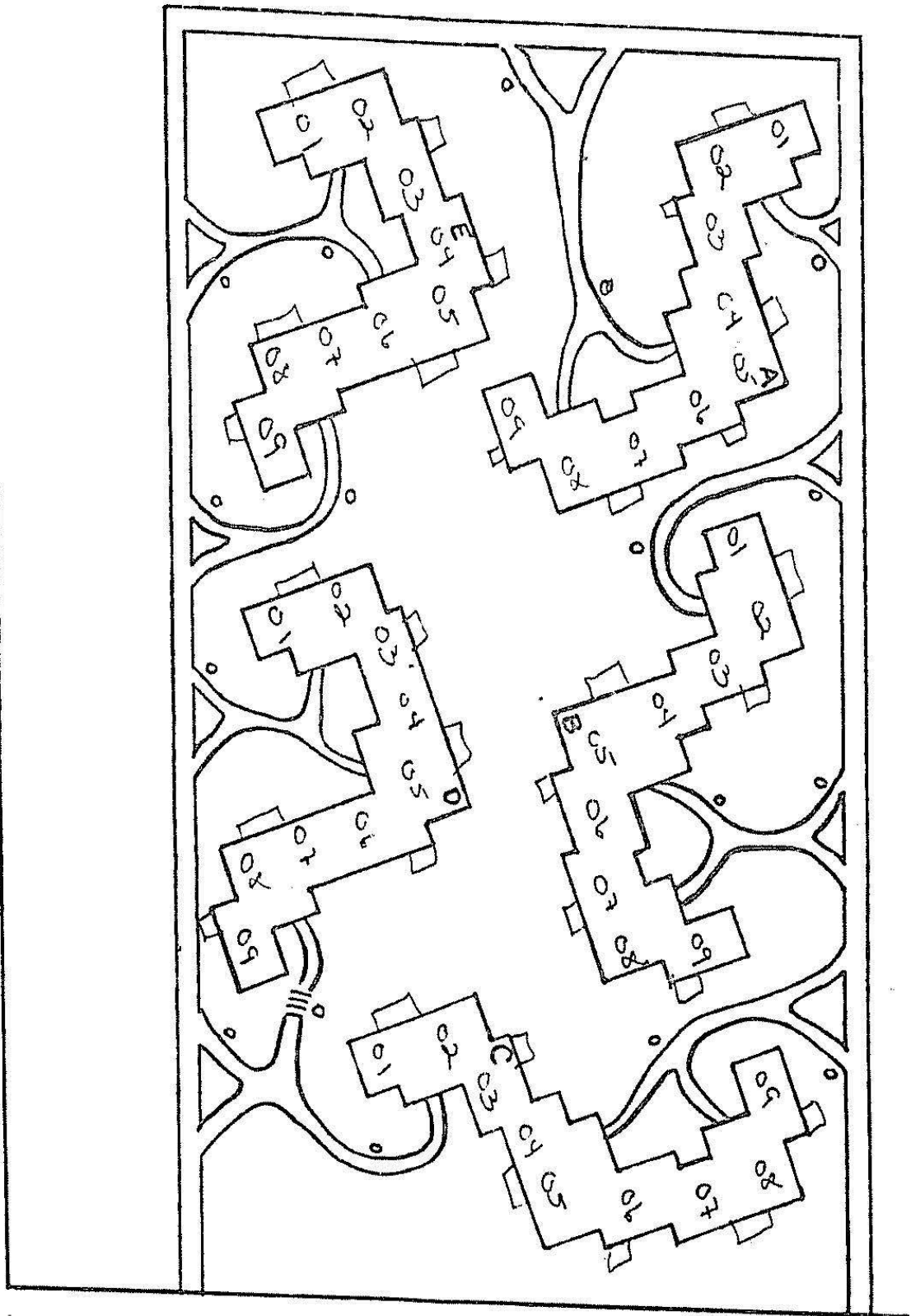

Steamboat

**Sotheby's**  
INTERNATIONAL REALTY

[steamboatsir.com](http://steamboatsir.com) | Main 970.879.8100 | Mountain 970.879.7800 | Downtown 970.870.8885

*\*This information is believed to be accurate but is not guaranteed, and is subject to change.\**