

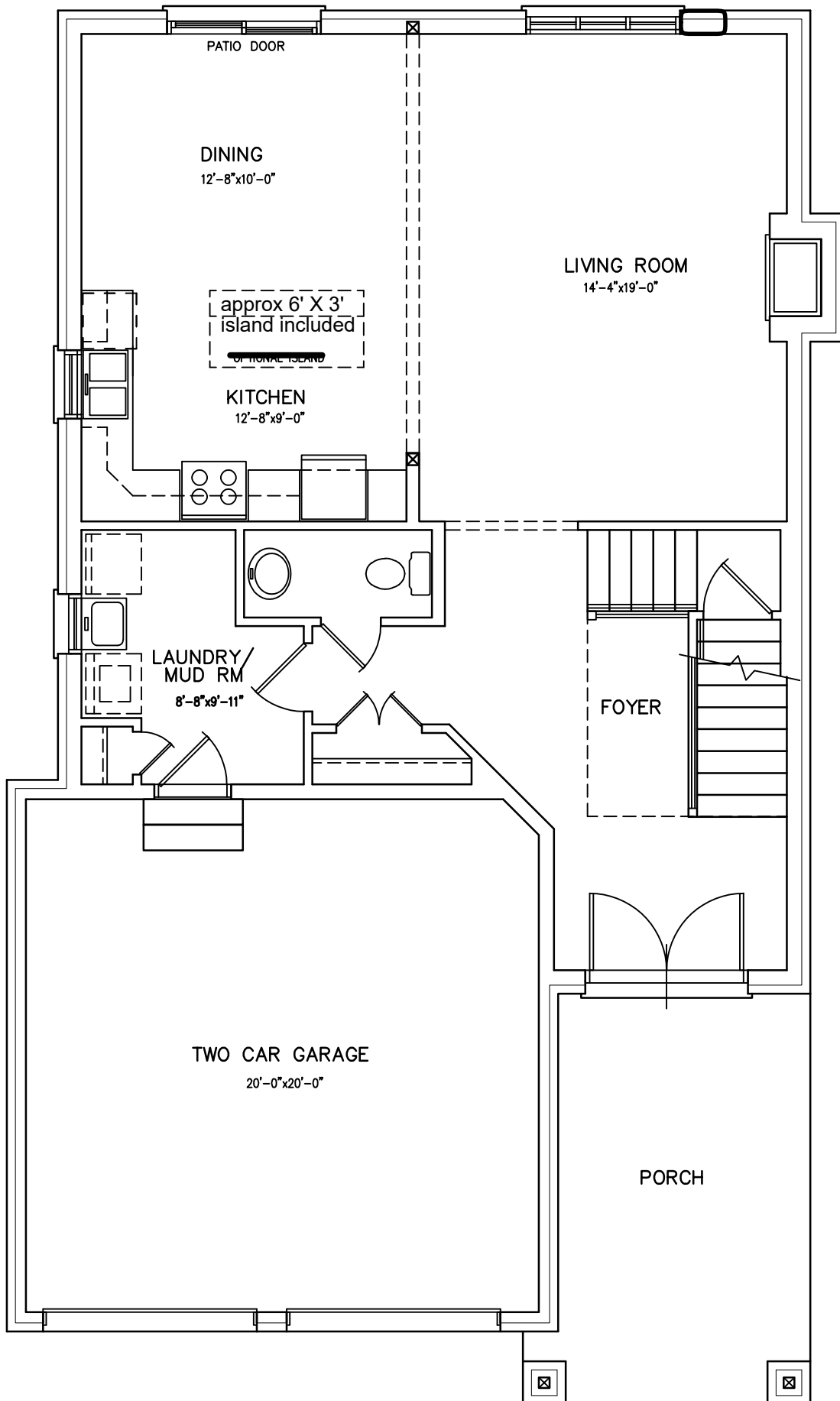

*Where the heart is*

**TF** team  
**FORSTER**  
REAL ESTATE PROFESSIONALS

Quadruple Casement Included



MAIN FLOOR PLAN — 983 sq.ft.

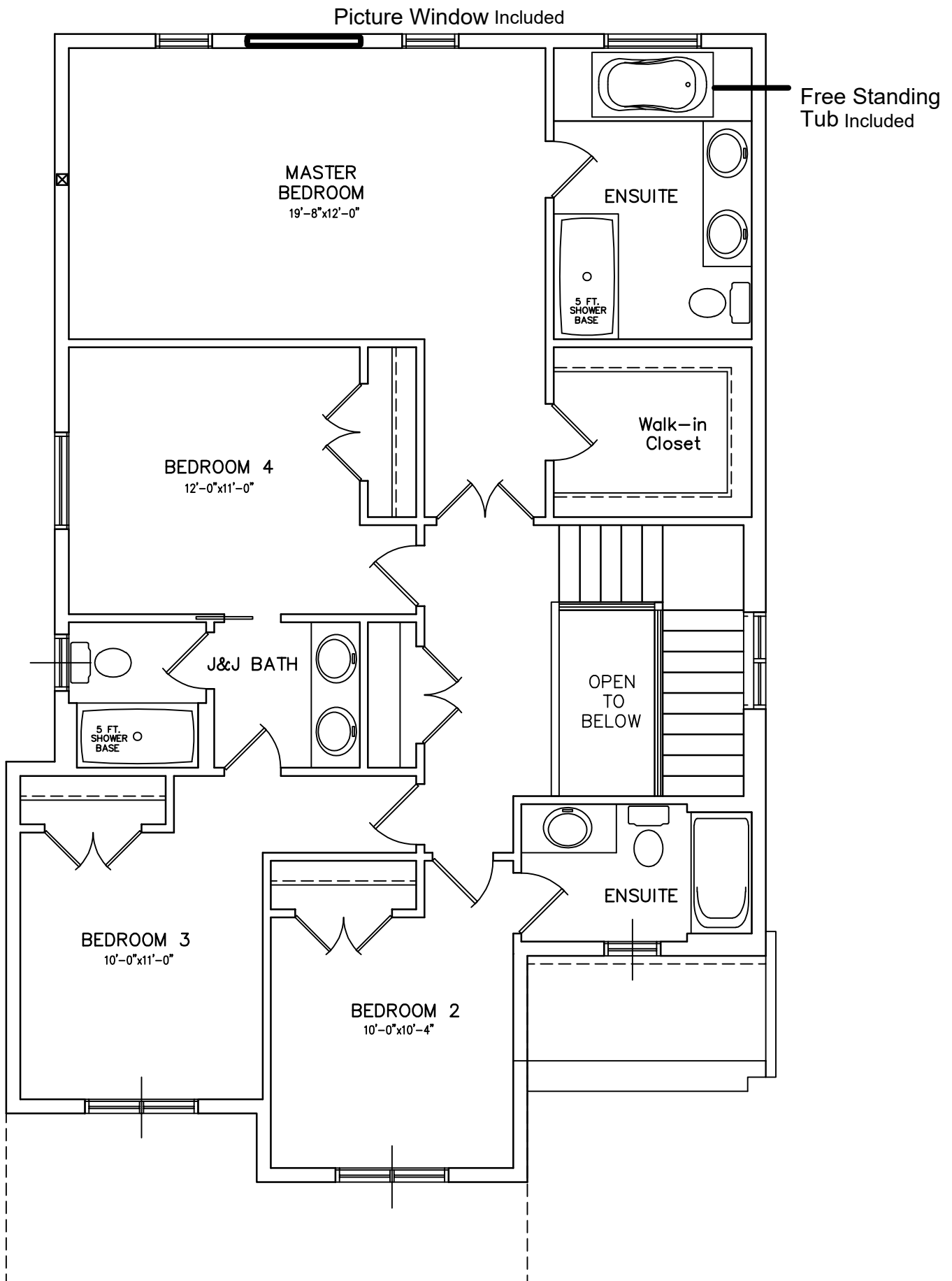

**SECOND FLOOR PLAN – 1272 sq.ft.**  
PLUS 30 SQ.FT. SPACE OPEN TO BELOW

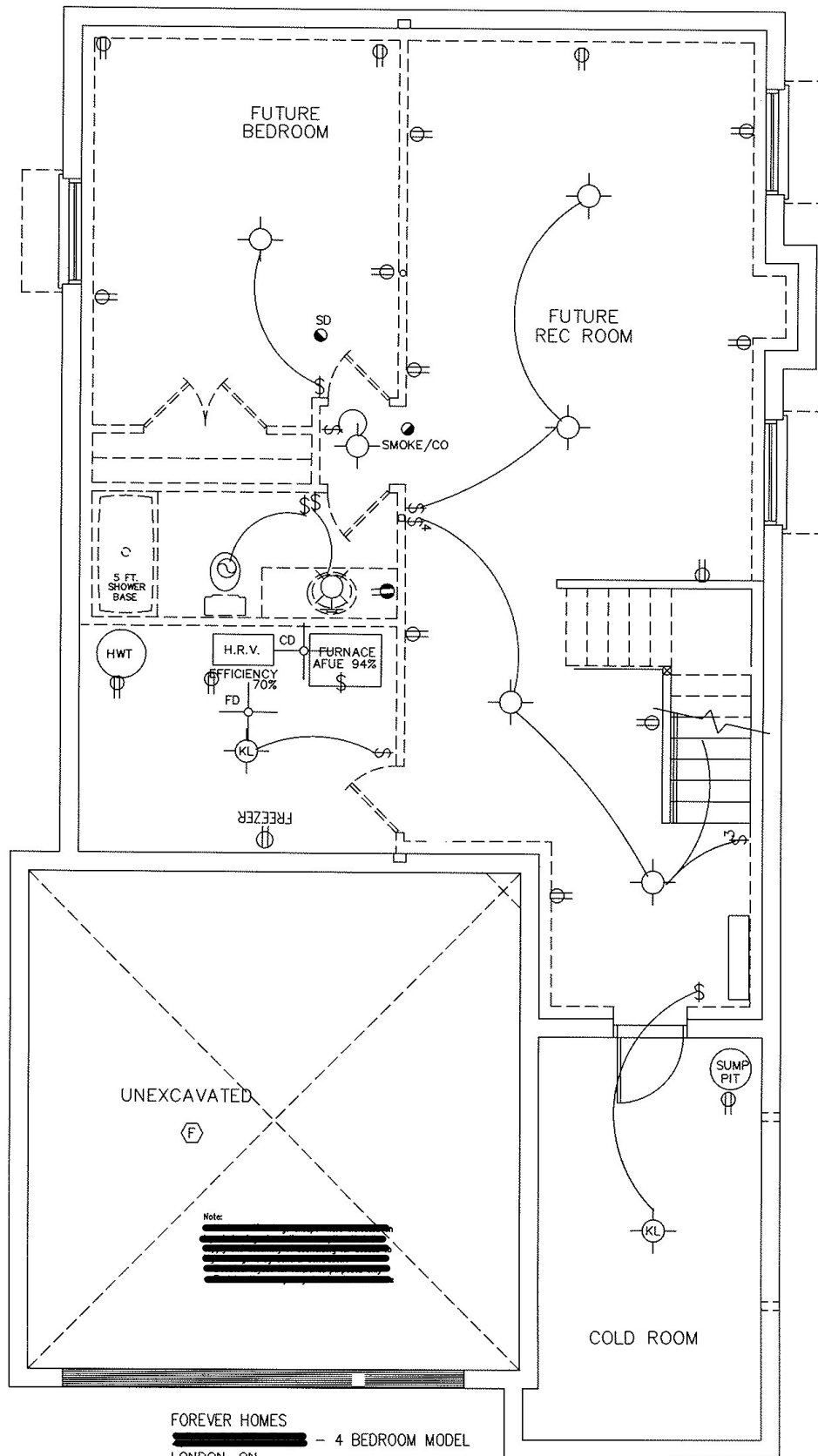

FOREVER HOMES  
 [REDACTED] - 4 BEDROOM MODEL  
 LONDON, ON  
OPTIONAL FINISHED BASEMENT PLAN  
 [REDACTED]